

Advantages

William Hackett WH-C4 manual chain blocks have been specifically designed to meet modern industry demands.

Compact and lightweight combined with strength and durability make the WH-C4 extremely robust and easy to handle.

The WH-C4 fully complies with and exceeds all the requirements of EN13157 and comes supplied with EN818-7 calibrated Grade 80 load chain. Each hoist is proof loaded to 1.5 times the Working Load Limit (W.L.L.) and has a guaranteed light load of 2% of the W.L.L.

WH-C4 hoists can be used in a temperature range of -40°C to +200°C exceeding the European standard for low temperature use.

WH-C4 manual chain blocks can be used at angles up to 45° from the vertical without W.L.L. deration. Guidance for the use of WH-C4 chain blocks used at angles can be found in the User Instruction Guide supplied with each hoist. Read the guidance notes thoroughly before using the WH-C4 blocks away from the vertical.



Design Features



Heavy duty forged steel latches create a strong and robust closure to the hoist hook



Both top and bottom hooks have two strategically forged marks on either side of the throat to allow easy measurement of the hook throat opening. Checking the distance between the marks as part of the pre-use inspection could indicate stretch of the hook due to overload. (measurement criteria can be found in C4 User Instructions).



Unique hand chain joiner allows for the safe and secure joining of hand chain, removing the need for welded or unwelded links

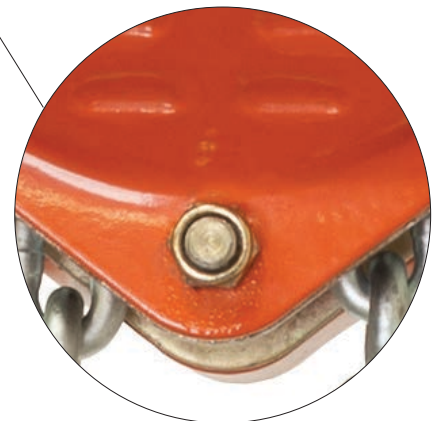

Nyloc securing nuts are fitted as standard



Calibrated load chain fully complies with EN818-7 as specified in BSEN13157



Nuts and bolts are used to secure hook yokes allowing disassembly of the yoke to allow full inspection of load hooks

Specific tions and Dimensions

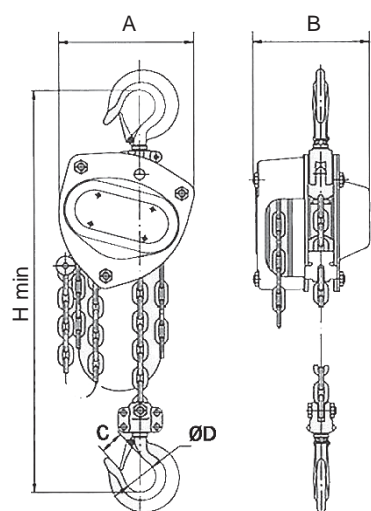

0.5t - 2t

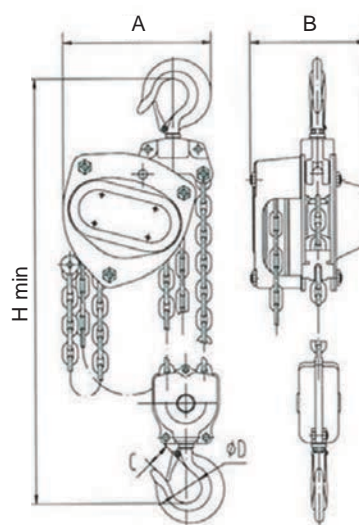

3t - 10t

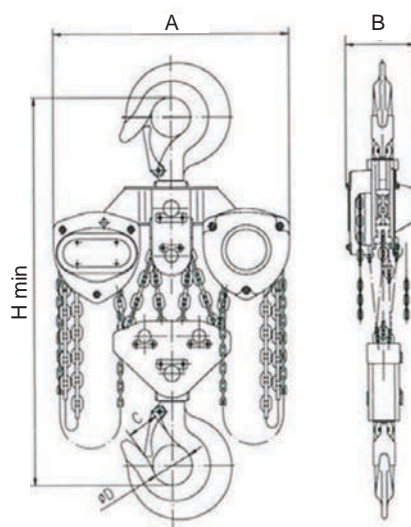

20t

Part Code	Capacity (t)	No. of Falls	Load Chain (mm)	Pull to Rated Load (N)	Hand Chain mm	Standard Lift (m)	Dimensions (mm)					Mass (Kg)	Extra Weight per M (Kg)
							A	B	C	D	H		
022.050	0.5	1	5 x 15	260	5 x 25 x 17	3	130	125	27	32	280	7.8	1.4
022.100	1	1	6 x 18	269	5 x 25 x 17	3	155	134	33	40	306	11.1	1.7
022.150	1.5	1	8 x 24	375	5 x 25 x 17	3	173	151	33.5	42	368	15.8	2.3
022.200	2	1	8 x 24	407	5 x 25 x 17	3	185	157	37	46	445	16.8	2.3
022.300	3	2	8 x 24	386	5 x 25 x 17	3	235	157	43.5	52	520	24.2	3.7
022.500	5	2	10 x 30	402	5 x 25 x 17	3	262	180	51	60	600	40.0	5.3
022/1000	10	4	10 x 30	380	5 x 25 x 17	3	433	189	50	85	800	80.7	9.6
022/2000	20	8	10 x 30	400 x 2	5 x 25 x 17	3	630	200	80	110	1000	180	19.2

Exploded Diagram and Parts List

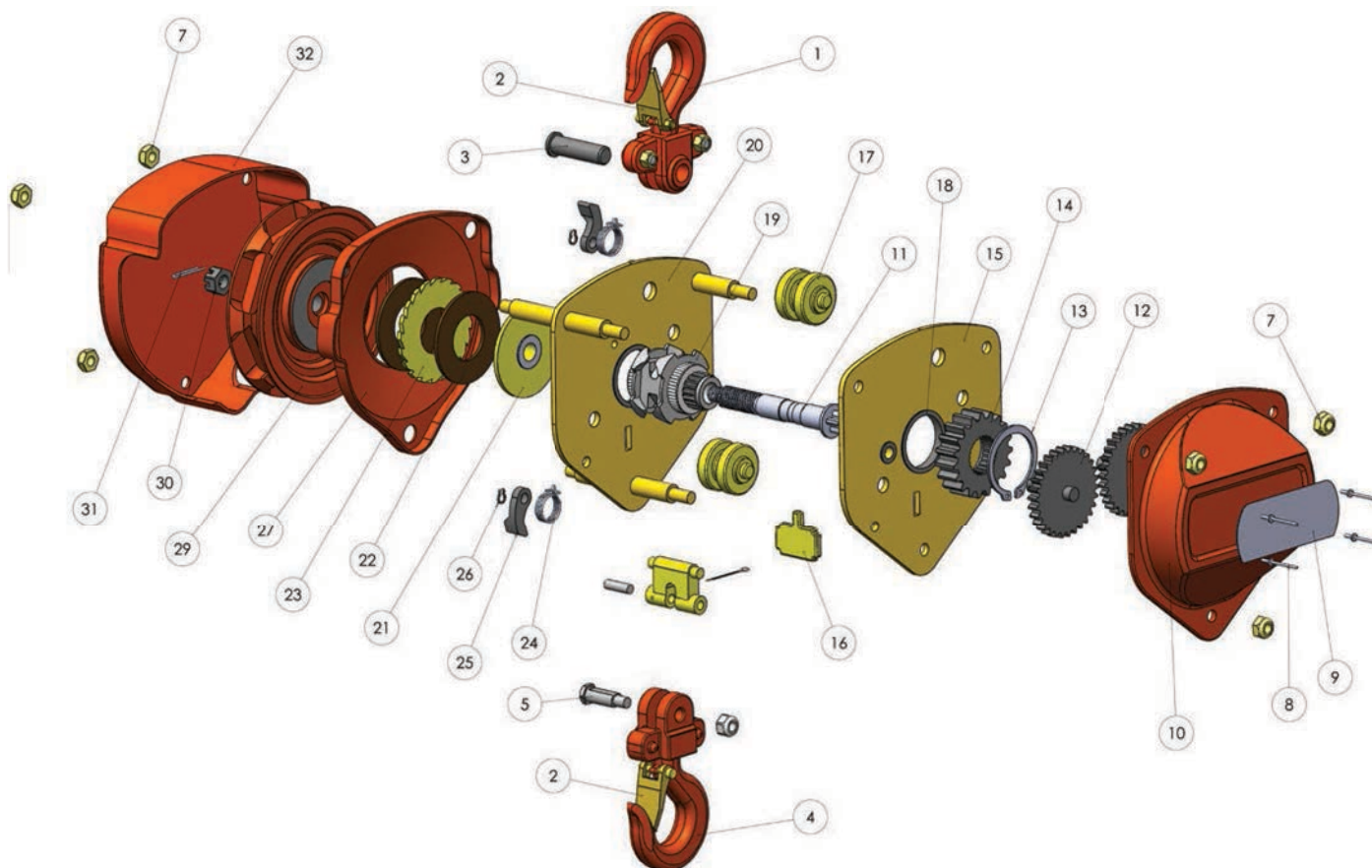

C4.01	Top Hook Assembly	C4.24	Pawl Spring	C4.47	Top Idle Sheave
C4.02	Safety Latch Assembly	C4.25	Pawl	C4.48	Lock Nut
C4.03	Top Hook Shaft	C4.26	Snap Ring	C4.49	Hook Assembly
C4.04	Bottom Hook Assembly	C4.27	Brake Cover	C4.50	Top Hook Shaft
C4.05	Bolt and Nut for Load Chain	C4.28	Hand Chain	C4.51	Bottom Hook Shaft
C4.06	Load Sheave	C4.29	Hand Chain Wheel	C4.52	Hook Shaft Snap Ring
C4.07	Nut	C4.29L	Overload Limiter Assembly	C4.53	Idle Shaft Snap Ring
C4.08	Rivet	C4.30	Pinion Nut		
C4.09	Label	C4.31	Cotter Pin		
C4.10	Gear Cover Assembly	C4.32	Hand Wheel Cover Assembly		
C4.11	Drive Shaft	C4.33	Chain Anchor Plate		
C4.12	Pinion Gear	C4.34	Split Pin		
C4.13	Snap Ring	C4.35	Chain Anchor Pin		
C4.14	Load Gear	C4.36	Top Hook Pin and Lock Nut		
C4.15	Gear Side Plate	C4.37	Socket Head Cap Screw		
C4.16	Stripper	C4.38	Bottom Hook Holder		
C4.17	Guide Roller	C4.39	Bottom Idle Shaft		
C4.18	Lift Wheel Snap Kit	C4.40	Roller Pin		
C4.18*	Caged Roller Bearings	C4.41	Bottom Idle Sheave		
C4.19	Load Sheave	C4.42	Lock Nut		
C4.20	Wheel Side Plate Assembly	C4.43	Socket Head Cap Screw		
C4.21	Disc Hub	C4.44	Top Hook Holder Assembly		
C4.22	Brake Disc	C4.45	Top Idle Shaft		
C4.23	Ratchet Disc	C4.46	Roller Pin		